

Works area

Longitudinal safety zone

Advance warning sign

If requested, signs to be positioned in suitable locations 1 week prior to work start date

Work starts here

xx xxx

DETAIL B

1.5m (3m relaxation)

120m

N.B. During darkness, warning lights to BS EN 12352:2006 should be provided in accordance with table A1.3 (Appendix 1)

On motorways and all purpose dual carriageways with hard shoulders on which national speed limit applies, 1m cones will be required for both standard works and works for which relaxations may be applied, for both lead in tapers and the facing wall on a lane change.

DETAIL C1

9m

100m

N.B. During darkness, warning lights to BS EN 12352:2006 should be provided in accordance with table A1.3 (Appendix 1)

For relaxation to Detail C1 see table A1.3 (Appendix 1)

DETAIL C2

3m

100m

N.B. During darkness, warning lights to BS EN 12352:2006 should be provided in accordance with table A1.3 (Appendix 1)

Phase	S.Head	T.Flow	Max Green	All Red	Location
1	A		40	15	Portsmouth road Eastbound
2	B		40	15	Portsmouth Road Westbound
3	C		35	10	Napier Road

Measure the distance between 'WAIT HERE' signs to datum point

Distance (metres)	0	50	100	150	200	250	300
All-Red time (seconds)	5	10	15	20	25	30	30
Distance (metres)	30	75	135	195	300		
Green time (seconds)	35	40	45	50			

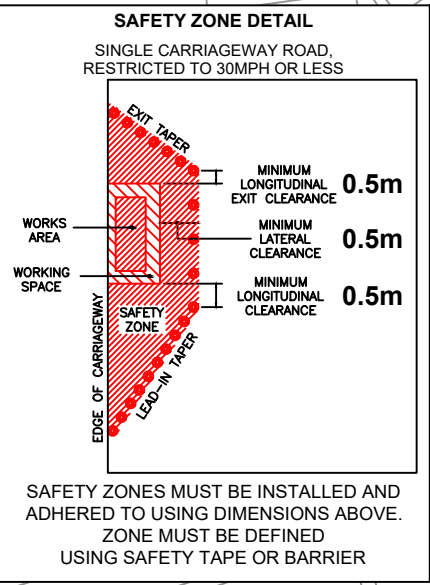

Qty: 3 Ref: 517 Road narrows on one side only ahead - left	
Qty: 3 Ref: 518 Single file traffic	
Qty: 3 Ref: 543 Traffic signals ahead	
Qty: 5 Ref: 610 Keep right	
Qty: 4 Ref: 610 Keep left	
Qty: 3 Ref: 645 End panel	
Qty: 6 Ref: 7001 Road works ahead	
Qty: 3 Ref: 7011.1 3 Way Control - Wait here until green light shows	